

# Installation Manual

## INF-GVIF



Manual Date		2020, 06, 09
Firmware Date	Main	2020, 06, 19
	Sub	2020, 06, 08
	Tw8823	2020, 06, 19

COMPONENTS

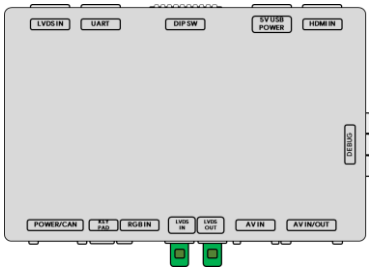

INF-GVIF

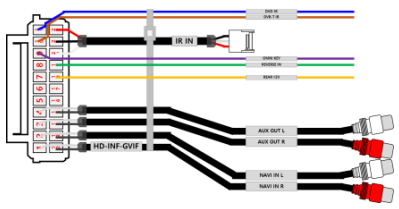

INF-GVIF Universal Cable

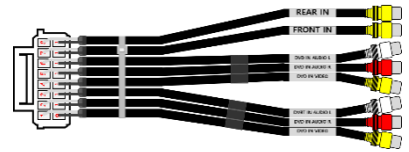

LVDS-Cable x 1pcs



Key-Pad



GVIF OUT B CABLE



GVIF IN A CABLE

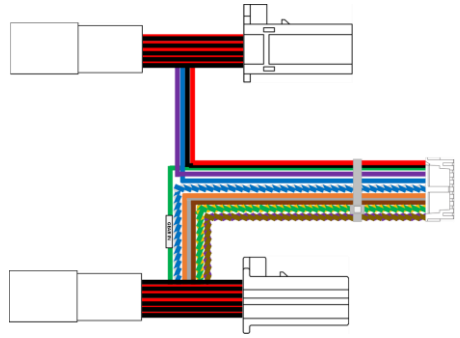

POWER CABLE

# PIN ASSIGNMENT

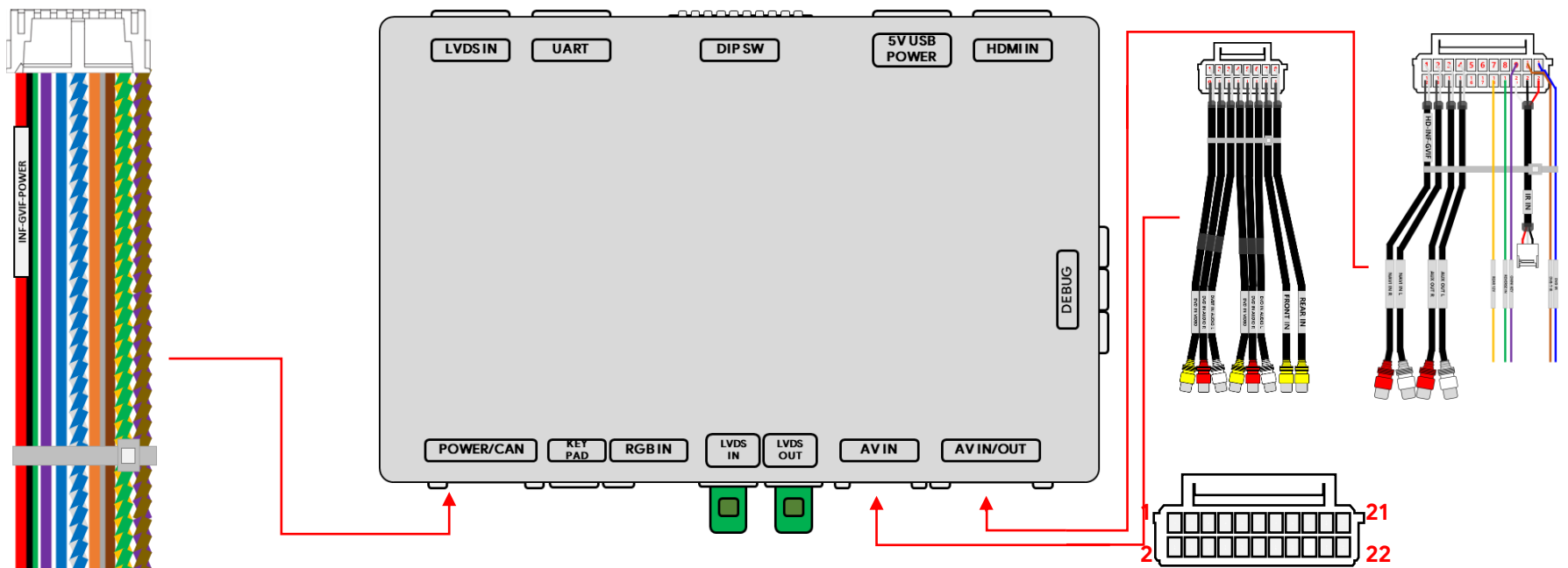

POWER / CAN			
1	ACC IN	2	Ground
3	GEAR IN	4	ST AD2
5	ST AD1	6	
7	ECU CAN H	8	ECU CAN L
9	MON TX	10	DEC RX
11	DUMMY TX	12	
13	PAD CAN OUT H	14	PAD CAN OUT L
15	PAD CAN IN H	16	PAD CAN IN L

AV IN	
1, 2	DVB-T Video
3, 4	DVB-T Audio R
5, 6	DVB-T Audio L
7, 8	DVD Video
9, 10	DVD Audio R
11, 12	DVD Audio L
13, 14	Front Camera
15, 16	Rear Camera

AV IN/OUT			
1	NAVI IN R	2	Ground
3	NAVI IN L	4	Ground
5	AUX OUT R	6	Ground
7	AUX OUT L	8	Ground
9		10	
11		12	
13		14	REAR 12V
15		16	REVERSE
17	OMNI_KEY	18	IR IN
19	DVBT-IR	20	Ground
21	DVD-IR	22	IR POWER



# INSTALLATION DIAGRAM

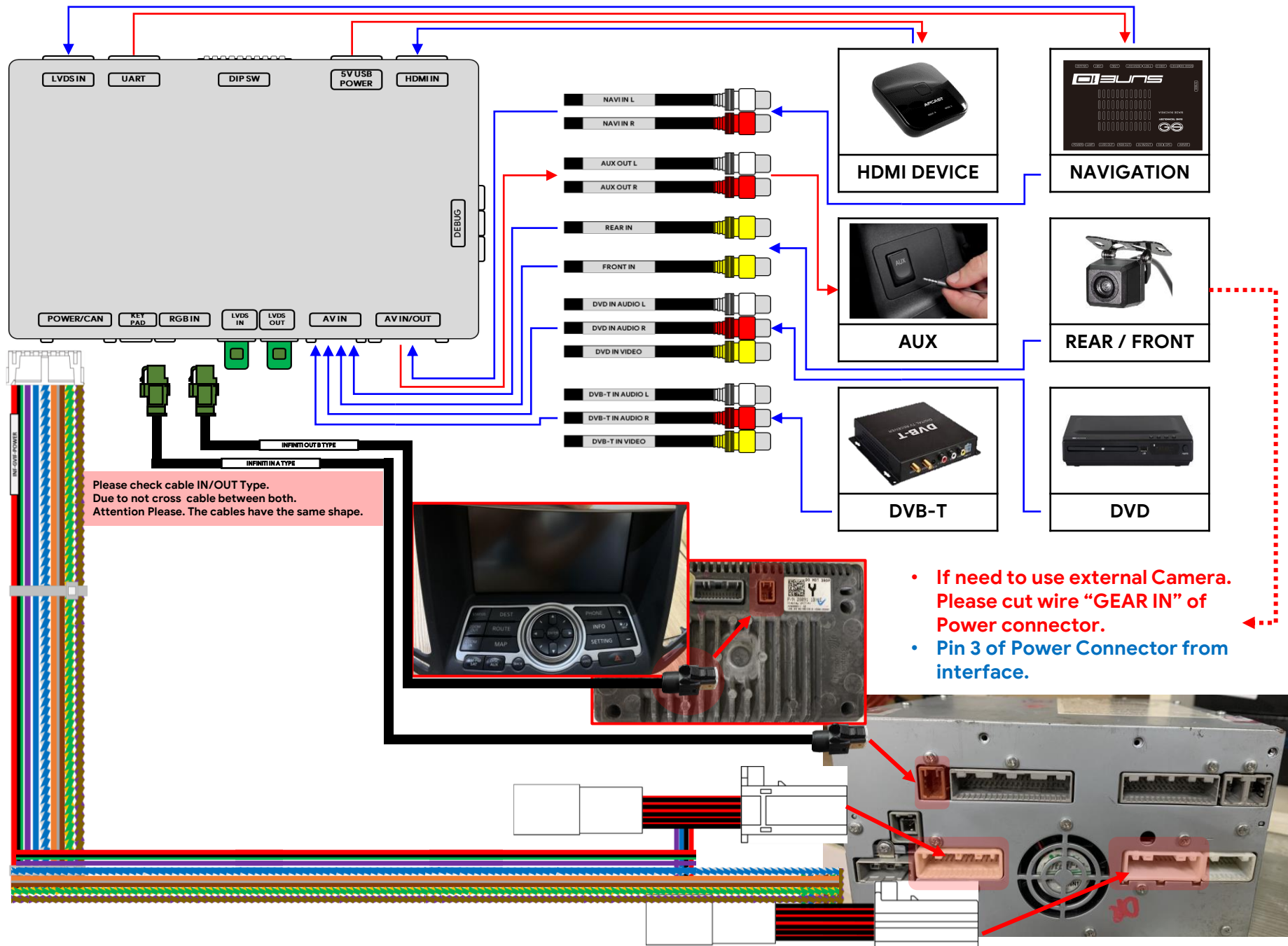

Please check cable IN/OUT Type.  
Due to not cross cable between both.  
Attention Please. The cables have the same shape.

- If need to use external Camera. Please cut wire "GEAR IN" of Power connector.
- Pin 3 of Power Connector from interface.



COMAND Controller	How to press	Description of operation
1, Map	Press button for short time	Return back to OEM Screen form Interface Screen
	Press button for 1 second	Screen is switched in that order switches are activated.
	Press button for 10 second	System would be reset.
2, Other Button	Press button for short time	Return back to OEM Screen form Interface Screen
3 Zoom In/Out	Press button for short time	In Android Mode It is working like Zoom In/Out on MAP
4. JOG Button	Press Button short time or Long time	In Android Mode It is Working like mouse.
5. Phone	Press button for 1 second	It would be switched between Front Screen And Others Screen.

Steer Remote	How to press	Description of operation
1, Back	Press button for short time	Return back to OEM Screen form Interface Screen
	Press button for 1 second	Screen is switched in that order switches are activated.

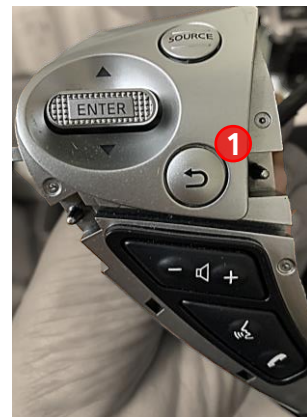

# INTERFACE SETTINGS

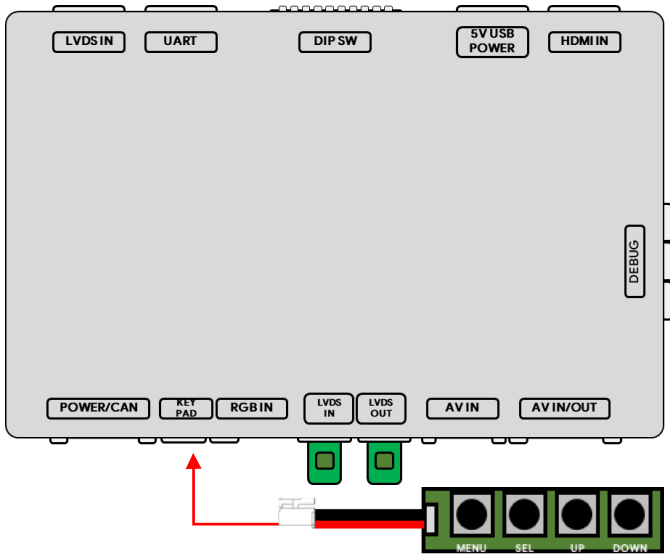

1920 x 720

HDMI	INPUT SOURCE	DEFAULT
NAVIGATION	BRIGHT	128
REAR VIEW	CONSTRASRT RED	128
FRONT VIEW	CONSTRASRT GREEN	128
DTV	CONSTRASRT BLUE	128
DVD		
CUSTOM		
EXIT		

DIP SWITCH INFO :

FIRMWARE DATE :

MAIN : 2019, 02, 03

SUB : 2019, 02, 03

TW23 : 2019, 02, 03

	How to press	In not settings menu.	In settings menu.
MENU	Press button for 1 sec	Screen is switched in that order switches are activated.	Return back to the previous menu.
SEL	Press button for short time	Enter into the settings menu.	Select the settings menu, and values
UP			Move the menu or Increase values
	Press button for 5 sec		Enter Calibration Mode For Touch.
DOWN			Move the menu or decrease values



SUNE TECHNOLOGY CO.,LTD No.9,Lane 606,Anping Rd,Tainan  
City 70849,TAIWAN TEL:+88662292246 FAX:+88662288104  
Http://www.sune-tech.com  
Shop <http://www.carnavi-tech.com>  
SKYPE:sune\_tech or hsin\_han99